

Hyatt Regency Jersey City On The Hudson

DIRECTIONS

By Land: 9 miles from Newark International Airport, the Hyatt Regency Jersey City is easily accessible from all major highways including the New Jersey Turnpike (I-95)

By Rail: Adjacent to the PATH (subway) station which allows for three minute trips to and from Manhattan; in addition, direct connections to Amtrak's Northeast Corridor, NJ Transit Rail Terminals in Newark and Hoboken

By Water: New York Waterway ferry service to Midtown Manhattan as well as the Financial District

3RD FLOOR

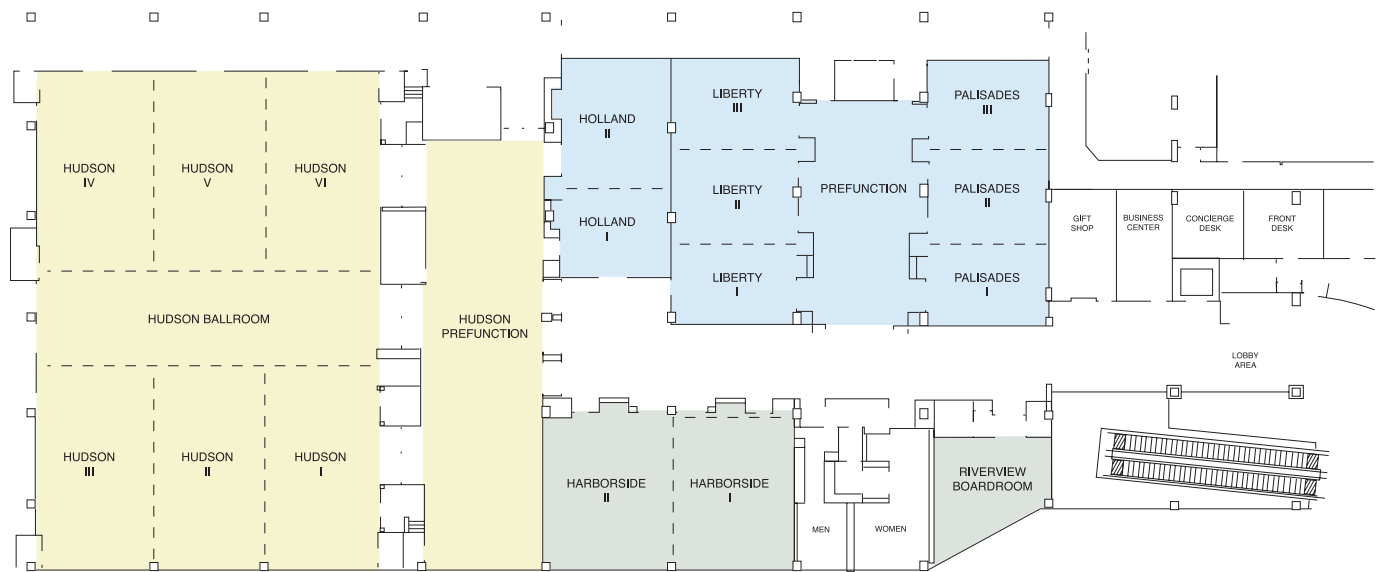

NINTH FLOOR MANHATTAN BALLROOM

